

# North-South Corridor

## Darlington Upgrade Project

### Pedestrian Detour and closure of bus stop 28 (westbound) Sturt Road, Tonsley

As part of the Darlington Upgrade Project, a detour for pedestrians on the southern side of Sturt Road between Laffer Drive and the Sturt Police Station, Tonsley, will be implemented from 6am on Tuesday 17 April 2018 for approximately three months.

Pedestrians using this section of Sturt Road will be detoured onto the northern side of Sturt Road, as outlined on the plan overleaf.

The detour is required in order to safely facilitate road, kerb and footpath reconstruction and drainage and services installation on this section of Sturt Road. These works are required for the new Sturt Road/Birch Crescent intersection.

Works will be undertaken from Monday to Saturday both during the day and at night. Some works may also be required on Sundays.

Excavators, a roller, a crane, trucks, light towers, a profiler, vac-truck and an asphalt machine will be used to undertake these works.

Bus stop 28 on Sturt Road (westbound) will be permanently closed from 6am on Tuesday 17 April.

Bus patrons will be required to use bus stop 27 or 29 (westbound) on Sturt Road.

Please plan ahead, allow extra travel time, take extra care when workers are on site and observe speed and lane restrictions when travelling through the area.

If you have any questions or would like to speak to a member of the project team please call 1300 759 334 or email: [enquiries@gatewaysouth.com.au](mailto:enquiries@gatewaysouth.com.au).

Kind Regards,  
Darlington Upgrade Project Team

12 April 2018



Australian Government

**BUILDING OUR FUTURE**



Government of South Australia

Department of Planning,  
Transport and Infrastructure

# North-South Corridor

## Darlington Upgrade Project



### Pedestrian detour and bus stop 28 closure Sturt Road, Tonsley

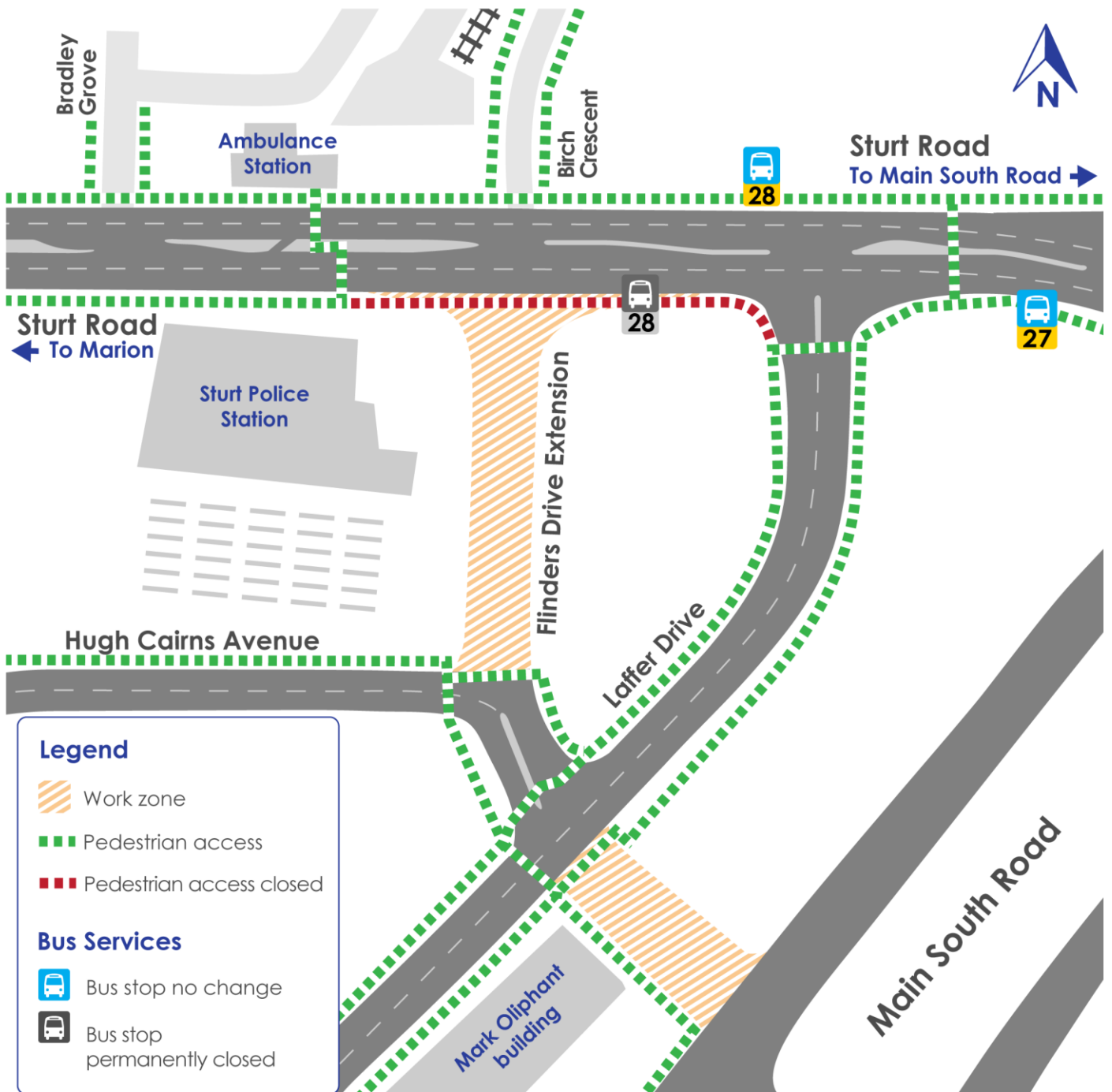

Australian Government

**BUILDING OUR FUTURE**



Government of South Australia

Department of Planning,  
Transport and Infrastructure