

South Eastern Freeway Pavement Rehabilitation – Bridgewater to Callington

Upcoming temporary ramp closures and heavy vehicle detours – start of works in the outbound lanes between Bridgewater Interchange and the Hahndorf/Woodside/ Birdwood Interchange

The Department for Infrastructure and Transport (the Department) is undertaking major pavement rehabilitation works on the South Eastern Freeway between Bridgewater and Callington.

Works west of the Mount Barker Interchange are funded by the Australian Government under the 2021-22 Periodic Maintenance Program. Works east of the Mount Barker Interchange are funded jointly (80:20) by the Australian and South Australian Governments under the Princes Highway Corridor Program.

The works involve removing existing pavement and replacing it with new asphalt to ensure the long term safety and integrity of the freeway for all road users.

Times of works

Works in the outbound lanes between the Bridgewater Interchange and the Hahndorf/Woodside/Birdwood Interchange **are scheduled to commence on Friday, 13 May 2022 and will take approximately three weeks to complete**, weather permitting.

To minimise the impact to road users, works will be undertaken at night between **7pm and 6am, Sunday to Friday**. No works will be undertaken on Saturday nights.

What to expect

During works speed and lane restrictions will be in place through the work zone for outbound traffic.

The Bridgewater Interchange outbound off-ramp will be closed for several nights during the work period. Speed and lane restrictions will be in place with a detour via the Hahndorf/Woodside/Birdwood Interchange, Mount Barker Road and Carey Gully Road.

The Bridgewater Interchange outbound on-ramp will also be closed for several nights during the work period. Speed and lane restrictions will be in place with a detour via Carey Gully Road, Mount Barker Road and the Stirling Interchange.

dit.sa.gov.au

Follow us on:    



Australian Government

BUILDING OUR FUTURE



Government
of South Australia

Department for Infrastructure
and Transport

Only one of the above ramps will be closed at a time and both ramps will be open outside of working hours.

Outside of work hours all lanes on the Freeway, Carey Gully Road and the Bridgewater Interchange ramps will be open to traffic with a 60km/h speed restriction in place.

Access for buses and emergency service vehicles will be maintained throughout the works.

Variable Message Signs will be in place at key locations to provide early notice to motorists of the traffic restrictions and detours.

Motorists should expect delays so please plan ahead and allow additional travel time. Please take extra care when workers are on site. Observe signage and speed limits, lane restrictions and traffic controllers when travelling through the area.

Some noise disturbance can be expected at times while these works are completed, however the work will be managed to minimise disturbance as much as practically possible. You may also notice some odour which is common when asphaltting works are underway.

Speed restrictions will remain in place on the newly resurfaced section of road to enable excess bitumen on the new surface to be worn to a safe level. The posted speed limit will then be reinstated once it is safe to do so.

Important information for heavy vehicles

During works on the Bridgewater Interchange, outbound vehicles **23 metres or more in length** will not be permitted to turn right from the Freeway on to Carey Gully Road and will be required to detour via the Mount Barker Interchange.

Please see the map overleaf for details.

Heavy vehicle operators should consider if permits are affected by the above restrictions. If you require an amendment to your permit, please contact the National Heavy Vehicle Regulator on 1300 696 487 or info@nhvr.gov.au

Please refer to the project website at www.dit.sa.gov.au/sefreewayrehabilitation or the Traffic SA website at www.traffic.sa.gov.au for details.

The Department appreciates your patience and cooperation while these important works are undertaken.

Further information

For details of upcoming works see the SA Infrastructure and Transport Facebook page.

For more information on the project, or to register for project updates, please contact the project team via the details below:

- visit: www.dit.sa.gov.au/sefreewayrehabilitation
- email: dit.communityrelations@sa.gov.au
- telephone: 1300 103 456

Kind regards

South Eastern Freeway Pavement Rehabilitation Project Team

May 2022

Bridgewater Interchange to Hahndorf/Woodside/Birdwood Interchange – outbound lanes

Heavy vehicle (23 metres or more) detour: Early May – late May 2022 (weather permitting)

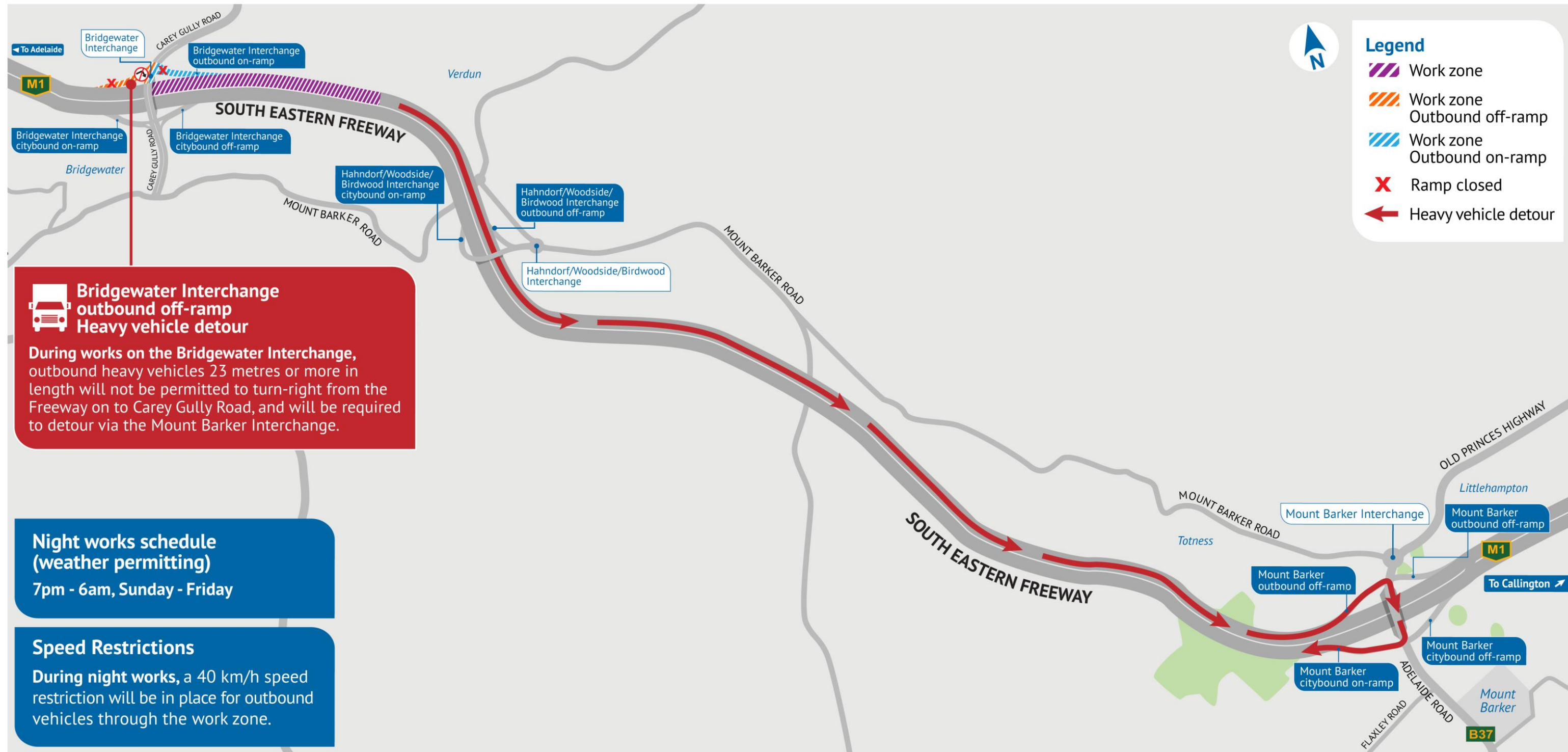

dit.sa.gov.au

1800 271 168

Follow us on:    



Australian Government

BUILDING OUR FUTURE



Government of South Australia
Department for Infrastructure
and Transport