

Darlington Upgrade Project

Lowered Motorway closures and access changes November 2020

As part of the Darlington Upgrade Project, night and weekend works will be undertaken in the lowered motorway and on South Road to install the final layer of asphalt and line marking, weather permitting. Please see times, closures and traffic management listed below.

4pm Wednesday, 25 November - 8pm Wednesday, 25 November

Changed access to Flinders Drive, Sturt Road and Mimosa Terrace from Southern Expressway (Map E1)

The northbound lanes exiting from the Southern Expressway onto the Main South Road surface road, including Flinders Drive will be closed. Motorists exiting the Southern Expressway to access Flinders Hospitals, Flinders Drive, Sturt Road or Mimosa Terrace will be required to exit onto Marion Road and right onto Sturt Road. Northbound lanes of the lowered motorway will remain open (**see red arrows on Map E1**).

8pm Wednesday, 25 November - 6am Thursday, 26 November

Lowered Motorway, northbound (Map E)

The northbound lanes of the lowered motorway will be closed. Northbound motorists on the Southern Expressway will be required to exit onto Marion Road, right onto Sturt Road, to the Main South Road surface road (**see the red arrows on Map E**).

5pm Thursday, 26 November - 8pm Thursday, 26 November

Changed access to Ayliffes Road (Map E)

Access from the lowered motorway to Ayliffes Road will be closed. Northbound motorists on the Southern Expressway will be required to exit onto the Main South Road surface road to access Ayliffes Road.

8pm Thursday, 26 November - 6am Friday, 27 November

Lowered Motorway, northbound (Map E)

The northbound lanes of the lowered motorway will be closed. Northbound motorists on the Southern Expressway will be required to exit onto Marion Road, right onto Sturt Road, to the Main South Road surface road (**see the red arrows on Map E**).

dit.sa.gov.au

Follow us on:    



Australian Government

BUILDING OUR FUTURE



Government
of South Australia

Department for Infrastructure
and Transport

To ensure the safety of all road users, speed and lane restrictions will remain in place outside of the hours of works.

Some noise disturbance can be expected at times while these works are completed, however the work will be managed to minimise disturbance to local residents as much as possible.

Once the works are complete, speed restrictions will remain in place along the newly resurfaced section for approximately six weeks, to enable excess bitumen to be worn to a safe level prior to the posted speed limit being reinstated, weather permitting.

Please plan ahead and allow extra travel time, and take extra care when workers are on site. Observe speed limits, lane restrictions and traffic controllers when travelling through the area.

Get real time traffic info direct to your smartphone by downloading our Addinsight app at www.addinsight.com.au/app or visit TrafficSA at www.traffic.sa.gov.au

If you have any questions or would like to speak to a member of the project team please contact us on 1300 759 334 or email: enquiries@gatewaysouth.com.au

Kind Regards,
Darlington Upgrade Project Team

25 November 2020

Lowered motorway closures - northbound

Map E1: 4pm Wednesday, 25 November - 8pm Wednesday, 25 November

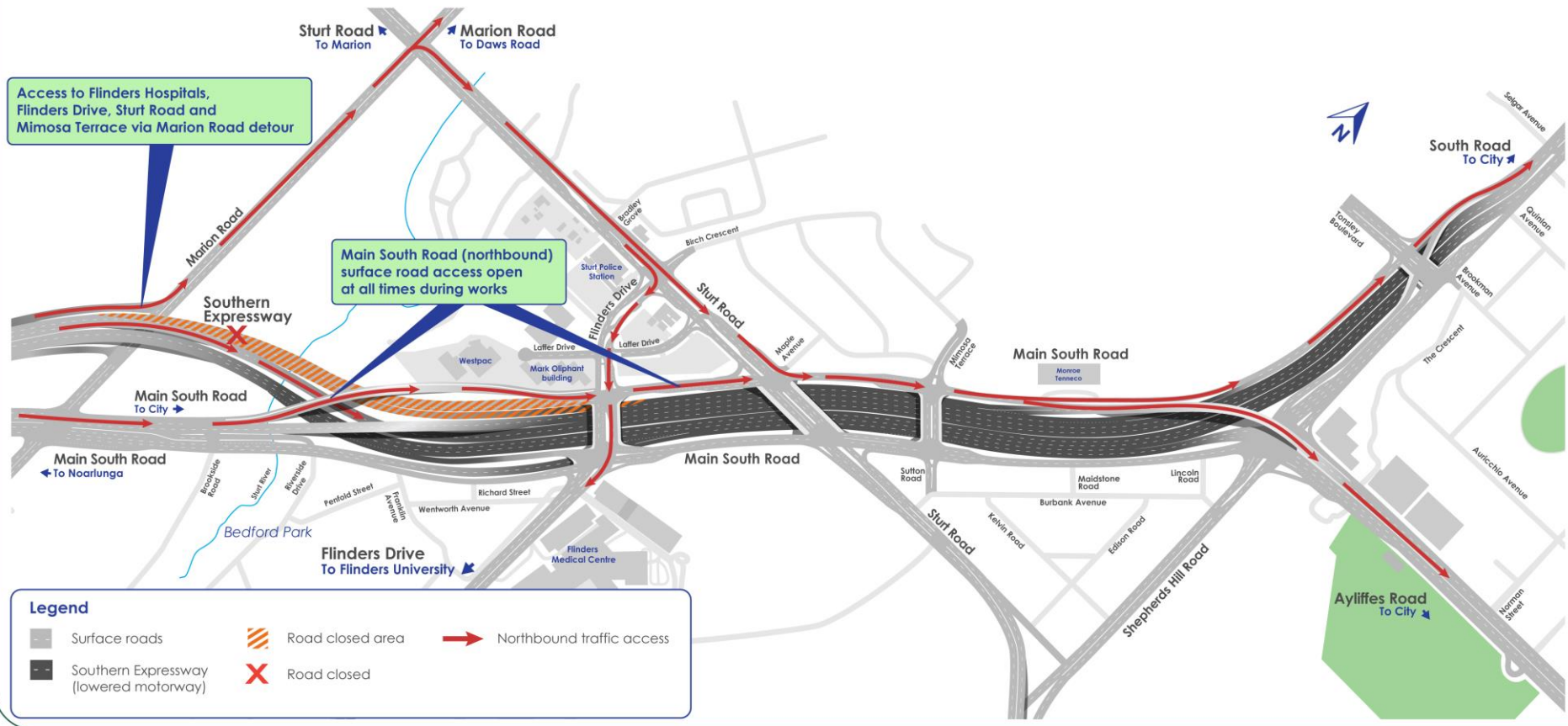

Lowered motorway closures - northbound; detour via Marion Road

Map E: 8pm Wednesday, 25 November - 6am Thursday, 26 November & 8pm Thursday, 26 November – 6am Friday, 27 November

