

ELEVATION 1b
SCALE 1:50

NOTE:
ELEVATION DRAWN FOR A RHS-BACKED THRIE-BEAM INSTALLATION. ELEVATION IS A DIGRAMMATIC REPRESENTATION OF THE BARRIER ASSEMBLY ONLY.
FOR SPANS <10m MINIMUM 4m MID LENGTH IS REQUIRED BETWEEN STRUCTURE TRANSITION AND END TERMINAL

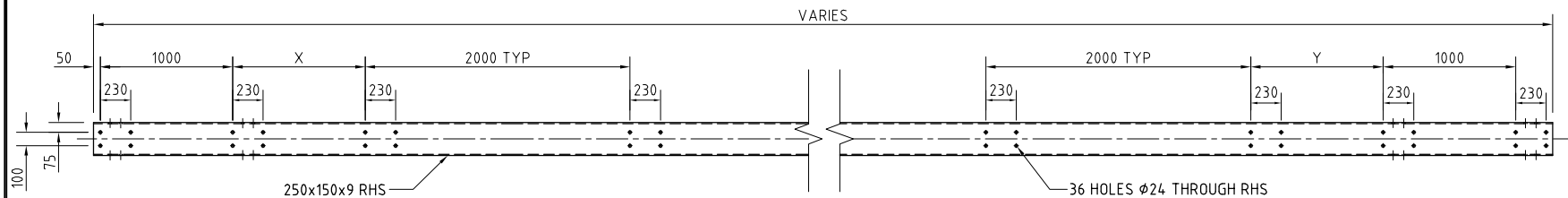

PLAN

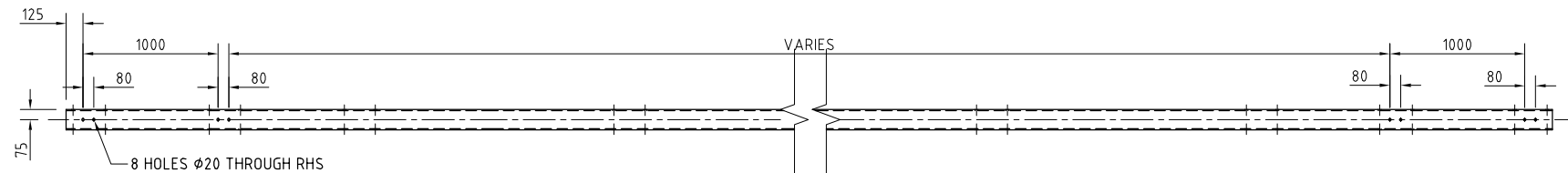

ELEVATION

BACKING RAIL
SCALE 1:25

NOTE: VARY DIMENSION 'X' AND 'Y' AND OVERALL RAIL LENGTH TO SUIT SITE LAYOUT. REFER TO SHEET 6 FOR TYPICAL RAIL DETAILS

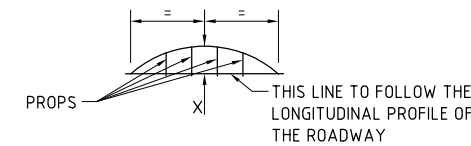

RAIL PRECAMBER DIAGRAM
NOT TO SCALE

PRECAMBER:
8m SPAN X = 10mm
12m SPAN X = 30mm
FOR INTERMEDIATE VALUES USE LINEAR
INTERPOLATION

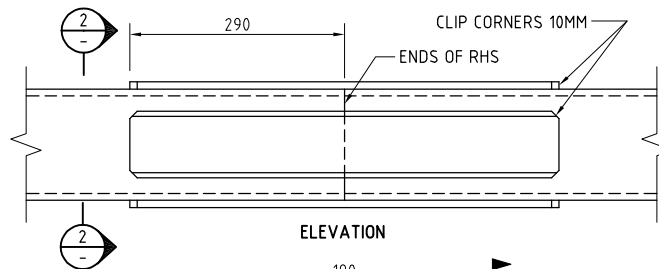

ELEVATION

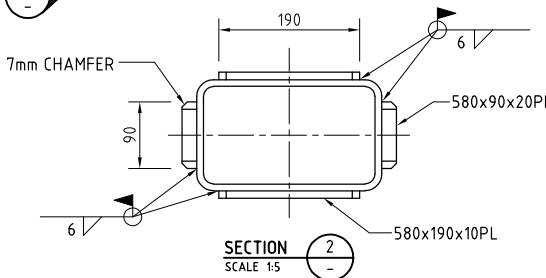

SECTION
SCALE 1:5

NOTE: 580x190x10PLS TO HAVE 2mm CAMBER AT C PLATE
ALTERNATIVELY PROVIDE FPBW V-PREP GRIND SMOOTH

TYPICAL RAIL SPLICE DETAIL
SCALE 1:5

| No. | AMENDMENT DESCRIPTION | BY | CHECK | ACCEPTANCE | DATE |
|-----|-----------------------|----|-------|------------|------|
|-----|-----------------------|----|-------|------------|------|

| | | | |
|--|---------------|------|------------|
| DESIGNED | QUALIFICATION | DATE | DD/MM/YYYY |
| REVIEWER | QUALIFICATION | DATE | DD/MM/YYYY |
| INDEPENDENT DESIGN CERTIFIER (IF REQUIRED) | QUALIFICATION | DATE | DD/MM/YYYY |

| | |
|---|--|
|  Government of South Australia | Department for Infrastructure and Transport |
|---|--|

| | | | |
|---|-----------------|----------------------------------|---------------------------------------|
| STANDARD DRAWING | | | |
| RHS-BACKED W-BEAM AND RHS-BACKED THRIE-BEAM | | | |
| RAIL, CAMBER AND SPLICE DETAILS | | | |
| BOX BEAM BARRIER SYSTEM UP TO 12M SPAN | | | |
| DESIGNED: DU | DRAFTED: DU | ACCEPTED FOR USE: PHIL MOLLOY | ACCEPTANCE FORM KNET No.: 16234483 |
| CHECKED: DU | REVIEWED: DU | DATE: 15/07/2021 | DRAWING No.: S-4082 |
| LATITUDE: | | SHEET No.: 3 | |
| LONGITUDE: | | AMEND No.: 0 | |