

South Eastern Freeway – Managed Motorway Measures Project

Dear Resident / Business Owner

The South Eastern Freeway Managed Motorway Project is jointly funded (50:50) by the Australian and South Australian governments. The project will convert the existing emergency lane into a third full-time travel lane and implement a Managed Motorway on both the up and down tracks of the South Eastern Freeway between Crafers and Stirling. The three lane Managed Motorway will include an Intelligent Transport System, with variable speed limits and a Lane Use Management system. This will enable the allocation and control of lanes across the freeway to improve safety and traffic flow (refer to attached map).

The project will be delivered in four stages, with updates provided for each stage in advance of works:

- Stage 1: shoulder construction (citybound and outbound carriageways).
- Stage 2: modification and works to the existing ramps.
- Stage 3: median construction including the installation of safety barriers.
- Stage 4: finishing, testing and commissioning works.

Stage 1: shoulder construction (citybound and outbound carriageways)

Stage 1 has seen the successful delivery of all Common Services Trenching works incorporating the lighting and the Intelligent Transport Systems (ITS) conduits. All light poles and LED street lighting are installed and all structural concrete and drainage works are complete. Installation of ITS structures, ITS equipment, asphalt and kerb works continue and are soon to be finalised.

Speed restrictions and modified lane widths have enabled the project team to progress works during the day, with some night works. To minimise disruption to traffic and local residents, the setup of temporary concrete barriers has limited the extent of active traffic control required. The works have required ramp and lane closures and your continued patience, and cooperation is greatly appreciated.

dit.sa.gov.au

Follow us on:    



Australian Government

BUILDING OUR FUTURE



Government
of South Australia

Department for Infrastructure
and Transport

Stage 2: modification and works to the existing ramps

Late August to October 2020

Works include:

- hauling cable for the ITS system (through the new conduit system);
- installation of ITS structures and ITS equipment;
- installation of variable message signs and over lane ITS gantries; and
- asphalt works, temporary line marking, kerbing and the installation of safety barriers.

Temporary concrete barriers will be removed in early September to enable Stage 2 works to progress.

Speed restrictions and changes to lane widths will continue to be required during the work. Day works will take place from Monday to Saturday, at the following times:

- Works on the citybound (**Stirling to Crafers**) carriageway will be undertaken between 9am and 7pm.
- Works on the outbound (**Crafers to Stirling**) carriageway will be undertaken between 6am and 3:30pm.

Night works will be undertaken as required between the hours of 7pm and 6am, however are not planned to take place on Saturday nights.

A speed restriction of 60km/h will apply for the duration of the Stage 2 works, including peak periods. At times a speed restriction of 40km/h will apply, when required.

Access for road users will be maintained with two lanes in each direction, except during some day works (outside of peak periods) and some night works, where one lane will remain open in each direction. Lane and other speed restrictions may apply, subject to onsite conditions.

Temporary on and off-ramp closures will be required during the installation of some ITS infrastructure and for construction of on-ramp asphalt works. Access to the Freeway will be maintained from either Crafers or Stirling at all times and a detour will be in place during the construction of these works. There will be no concurrent closures of on-ramps and off-ramps.

The works will require the closure of the outbound Crafers on-ramp on the dates listed below.

- Monday, 31 August, between 12midnight and 6am to remove concrete barriers.
- Tuesday, 1 September, between 7pm and 6am for excavation to pavement base.
- Monday, 7 September, between 7pm and 6am for placement of asphalt.
- Tuesday, 8 September, between 7pm and 6am for placement of asphalt.

Detours will be in place during the works (see detour map below)

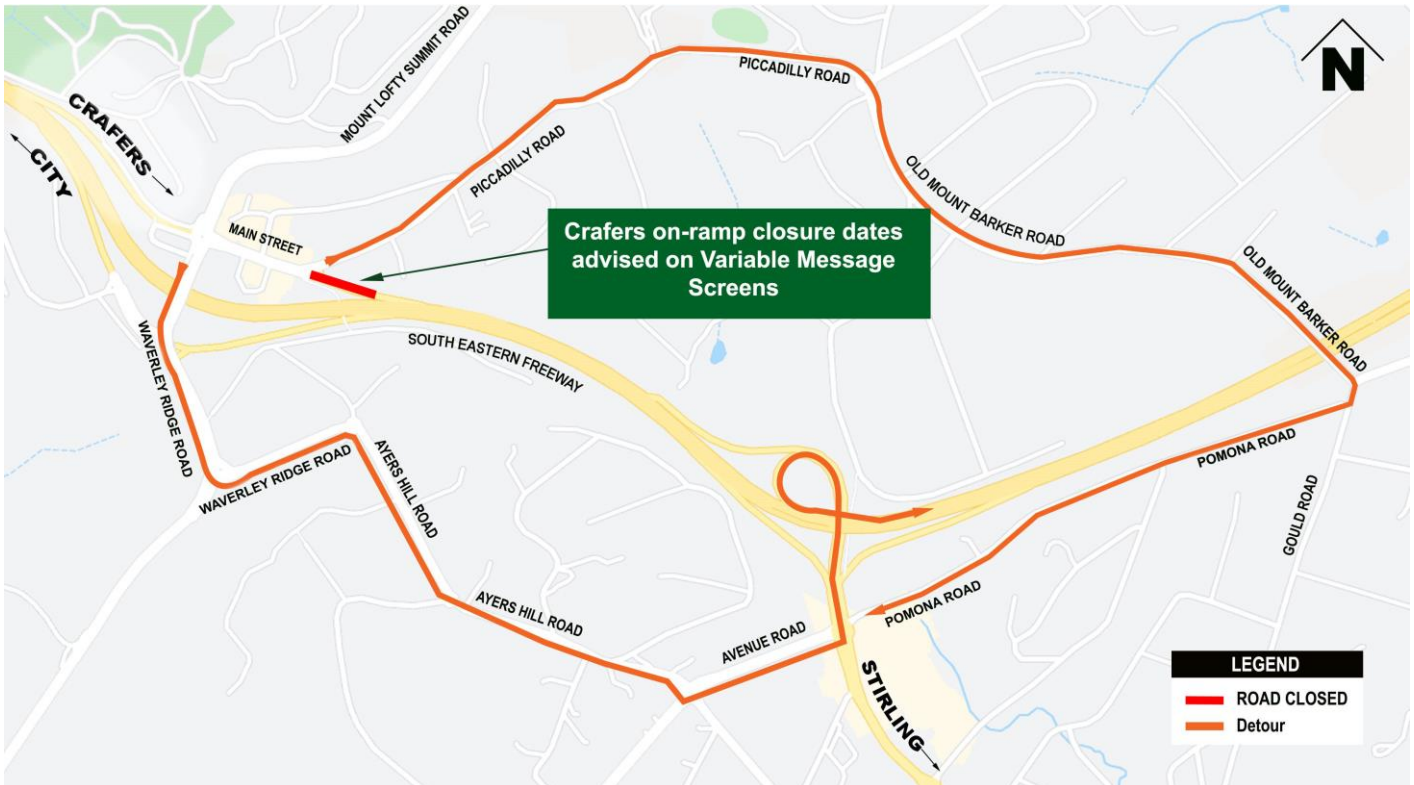

Road users are asked to please plan ahead and allow extra travel time, observe speed limits, lane restrictions, traffic controllers and take extra care when travelling through the area and on any detours.

Temporary variable message signs will be in place to direct motorists, however if you would like notification in advance of ramp closures, please email the Department on the address below to be included in the project distribution list.

The pedestrian bridge crossing at Crafers will remain open at all times.

Some noise disturbance and temporary inconvenience from construction activities can be expected at times while these works are completed, however the work will be managed to minimise disturbance to local residents and road users as much as practically possible.

Stage 3: median construction including the installation of safety barrier

Stage 3 works are expected to commence in October 2020, and will include the construction of the median and the installation of safety barrier. This stage is expected to be completed by the end of 2020.

Stage 4: finishing, testing and commissioning works

Stage 4 finishing, testing and commissioning works are expected to commence and be completed in early 2021, weather permitting.

Main works are expected to be completed by the end of the year, weather permitting, with testing and commissioning to take place in early 2021.

Your patience and cooperation whilst these important works are undertaken is appreciated.

Department for Infrastructure and Transport COVID-19 Response

The Department will continue to tailor community engagement opportunities in line with the latest COVID-19 advice from health authorities.

Face-to-face engagement opportunities may be restricted and we will continue to be guided by the advice of health authorities, with the health and safety of our stakeholders always our highest priority.

We encourage the community to register for email updates via the website below.

For further information or to speak to a member of the project team please contact:

- **Email:** DIT.communityrelations@sa.gov.au.
- **Phone:** 1300 794 880
- **Visit:** www.dit.sa.gov.au/infrastructure/road_projects/managedmotorway.

South Eastern Freeway - Managed Motorway Project

