

Nottage Terrace and North East Road Intersection Upgrade

Ongoing works and temporary traffic changes

The Australian and South Australian governments have jointly funded (50:50) the \$6 million Nottage Terrace and North East Road Intersection Upgrade. The upgrade is expected to support approximately 10 full-time equivalent jobs over the life of the project.

What to expect

As part of this project night works will continue for the installation of drainage, road lighting, traffic signals and asphalt at various locations through and around the intersection of North East Road, Nottage Terrace and adjacent side streets until **late-April 2023**.

These works will take place between the hours of **7pm and 6am, Sunday to Thursday with intermittent Friday night works, if required**, weather permitting.

There will be no night works on Sunday, 12 March and Monday, 13 March 2023 due to the public holiday.

Day works will continue to be undertaken **between the hours of 7am and 6pm, Monday to Friday**. The intersection of North East Road and Nottage Terrace will remain open to traffic at all times during day works with speed and lane restrictions in place. Please take extra care when workers are on site. Observe speed limits, lane restrictions and traffic controllers when travelling through the area.

Temporary traffic changes

Nottage Terrace will be reduced to one lane in each direction **during night shifts from Tuesday, 14 March to Friday, 17 March 2023 and Sunday, 26 March and Monday, 27 March 2023**, between 7pm to 6am, weather permitting. This is required to replace existing asphalt along Nottage Terrace.

There will be some short-term access impacts to adjacent side streets and to properties on Nottage Terrace and Ettrick Avenue in the work area, during these works. The project team will contact affected property owners and residents directly. Traffic controllers will be on-site to facilitate local access and detour signage will be in place. Pedestrians and cyclists are advised to take care when travelling through the area.

Refer to the map overleaf titled '*Nottage Terrace Night Works*' for details of the above arrangements.

The following traffic arrangements will be in place **during night shifts from Tuesday, 28 March and Wednesday, 29 March 2023**, to lay the final wearing course of asphalt on the western side of the intersection of North East Road and along Nottage Terrace between the intersection and Victoria Road:

- Nottage Terrace will be reduced to eastbound traffic only;
- local access will be maintained to both sides of Nottage Terrace; and
- no access to westbound lanes of Nottage Terrace at its intersection with North East Road/ Northcote Terrace and Stephen Terrace, detour via main arterial roads.

Refer to the map overleaf titled '*Nottage Terrace, Northcote Terrace and North East Road intersection night works*' for details of the above arrangements.

dit.sa.gov.au

Follow us on:    



Australian Government



Government of South Australia

Department for Infrastructure and Transport

OFFICIAL

The following traffic arrangements will be in place **during night shift from Thursday, 30 March 2023**, to lay the final wearing course of asphalt on the eastern side of the intersection of North East Road:

- eastbound lanes of Stephen Terrace will be closed at the intersection of North East Road;
- traffic traveling on North East Road and Nottage Terrace wanting to access Stephen Terrace will be detoured via Northcote Terrace and Walkerville Terrace;
- traffic coming from North Adelaide wanting to access Stephens Terrace will be detoured via Walkerville Terrace; and
- local traffic will have access to the eastbound lanes on Stephen Terrace east of the intersection of North East Road and Northcote Terrace.

Refer to the map overleaf titled '*Stephen Terrace, Northcote Terrace and North East Road intersection night works*' for details of the above arrangements.

Traffic controllers will be on-site to assist local access and detour signage will be in place. Pedestrians and cyclists are advised to take care when travelling through the area.

Emergency services vehicle access will be maintained at all times.

Some noise disturbances can be expected at times while these works are completed, however, the work will be managed to minimise disturbance to nearby residents as much as practically possible. This includes scheduling more intrusive works in the early evening, where possible. You may also notice some odour which is common when asphaltting works are underway.

The Department appreciates your patience and cooperation whilst these important works are undertaken.

Further information

To find out more about the project or register for future updates, please contact the project team by:

- visiting dit.sa.gov.au/nottage_notheast
- Calling 1300 794 880
- email: DIT.NottageNorthEast@sa.gov.au

Kind Regards,

Nottage Terrace and North East Road Intersection Upgrade project engagement team

Nottage Terrace night works

Tuesday 14 to Friday, 17 March 2023 and Sunday 26 to Monday 27, March 2023 between 7pm to 6am, (weather permitting)

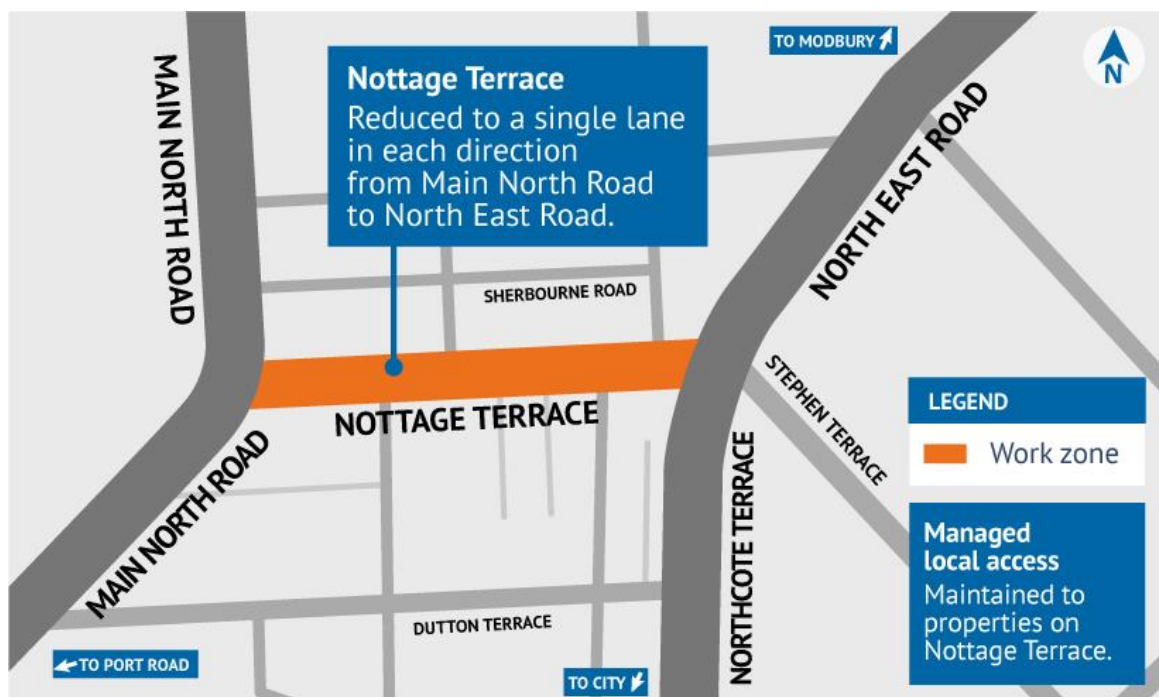

Nottage Terrace, Northcote Terrace and North East Road intersection night works

Tuesday 28 and Wednesday 29, March 2023, between 7pm to 6am, (weather permitting).

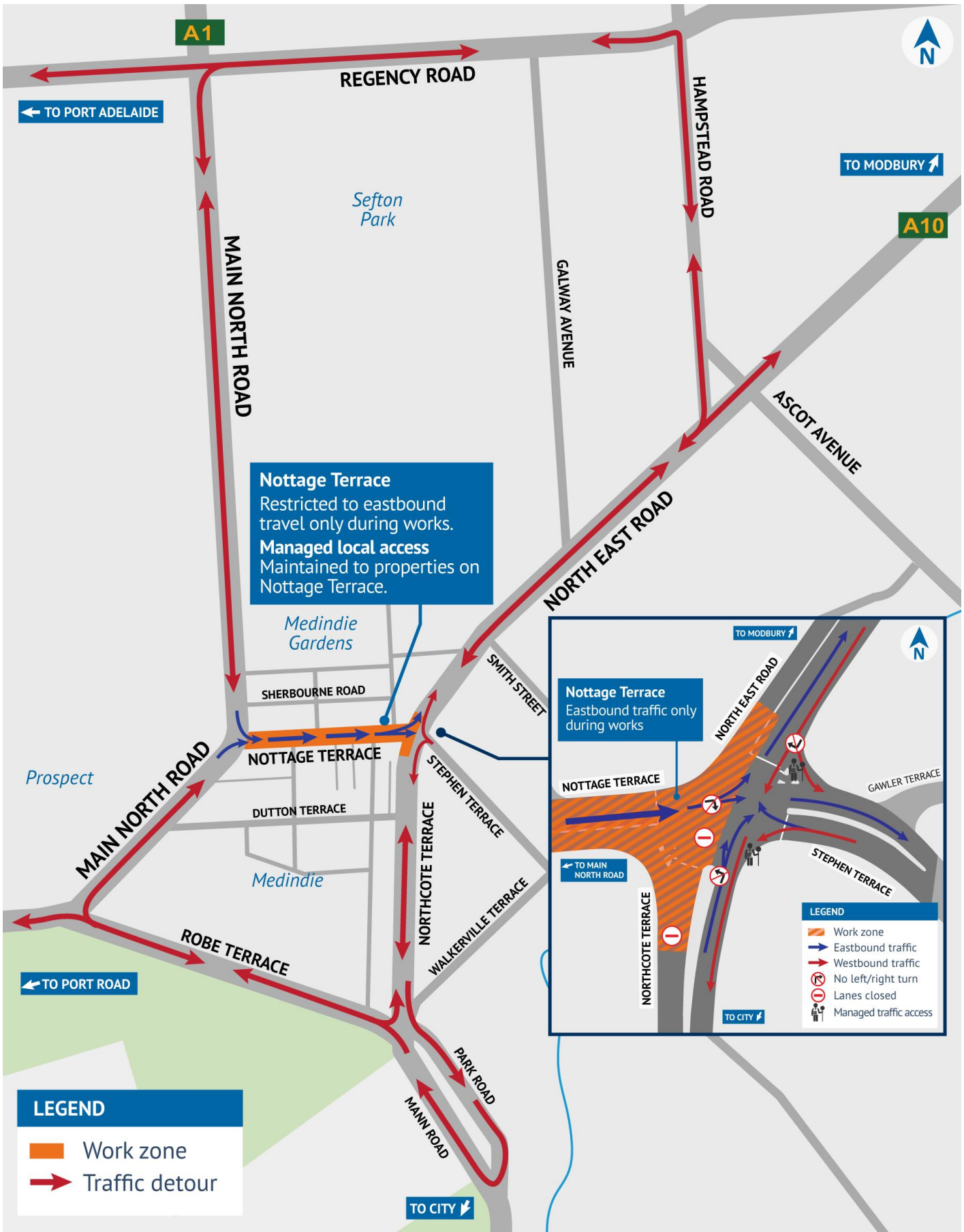

Stephen Terrace, Northcote Terrace and North East Road intersection night works

Thursday, 30 March 2023, between 7pm to 6am, (weather permitting).

