

Darlington Upgrade Project

Temporary closure of Franklin Avenue, Bedford Park From Tuesday, 10 March

As part of the Darlington Upgrade Project, changed traffic arrangements will be in place from Tuesday, 10 March, for pavement and kerbing works to be undertaken at the Franklin Avenue junction with Main South Road, Bedford Park.

To safety facilitate these works, Franklin Avenue will be temporarily closed at the junction with Main South Road, commencing on Tuesday, 10 March for approximately three weeks; works will occur between the hours of 6am and 7pm.

The following traffic arrangements will be in place:

- Riverside Drive will remain open.
- Richard Street will remain closed.
- Pedestrian access on Franklin Avenue will be maintained.
- Access to properties will be maintained.
- Lane and speed restrictions will apply on Main South Road in the vicinity of the works.
- Signage will alert motorists to the changed traffic conditions.

Please see map overleaf for further details.

Some noise disturbance can be expected at times while these works are completed, however the work will be managed to minimise disturbance to local residents and businesses as much as practically possible.

Access for emergency service vehicles will be maintained at all times during these works. The works will not affect access to the Flinders Medical Centre. There are no changes to public transport services, and pedestrian and cycle access will not be affected.

Please plan ahead, allow extra travel time, and take care when workers are on site. Observe speed and lane restrictions, and obey traffic controllers when travelling through the area.

If you have any questions or would like to speak to a member of the project team please call 1300 759 334 or alternatively email: enquiries@gatewaysouth.com.au.

Thank you for your patience while these important works are undertaken.

Kind Regards,
Darlington Upgrade Project Team

3 March 2020

Franklin Avenue closure

March 2020

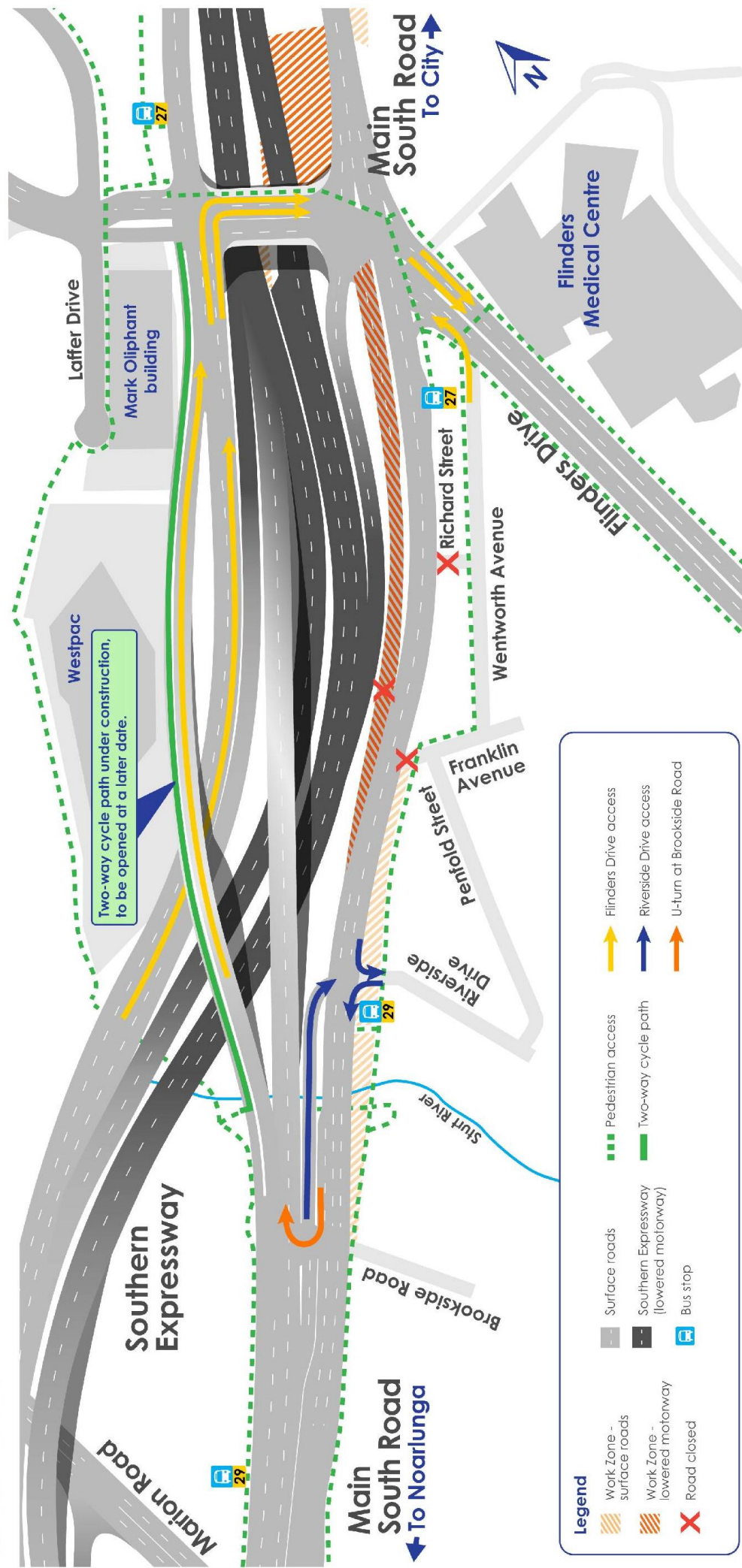

Two-way cycle path under construction, to be opened at a later date.

Legend

- Work Zone - surface roads
- Work Zone - lowered motorway
- Road closed
- Surface roads
- Southern Expressway (lowered motorway)
- Bus stop
- Pedestrian access
- Two-way cycle path
- Flinders Drive access
- Riverside Drive access
- U-turn at Brookside Road