

# South Eastern Freeway - Managed Motorway Measures Project: Ramp Closures

Dear Resident / Business Owner,

**The South Eastern Freeway - Managed Motorway Measures Project, jointly funded (50:50) by the Australian and South Australian governments, is scheduled to undertake temporary ramp closures throughout September 2020, weather permitting.**

The Managed Motorway Measures Project will convert the existing emergency lane into a third full time travel lane and implement a Managed Motorway on both the up and down tracks of the South Eastern Freeway between Crafers and Stirling. The three lane Managed Motorway will include an Intelligent Transport System, with variable speed limits and a Lane Use Management system. This will enable the allocation and control of lanes across the freeway to improve safety and traffic flow. To complete these works safely and efficiently, ramp closures are required.

Ramp closures are scheduled on the dates below with temporary detours in place during the works.

## Crafers Outbound On-Ramp

- Friday, 11 September, between 7:00pm - 6:00am for profiling to remove existing pavement
- Sunday, 13 September, between 7:00pm - 6:00am for profiling to remove existing pavement
- Monday, 14 September, between 7:00pm - 6:00am for profiling to remove existing pavement
- Tuesday, 15 September, between 7:00pm - 6:00am for placement of asphalt
- Thursday, 17 September, between 7:00pm - 6:00am for placement of asphalt
- Friday, 18 September, between 7:00pm - 6:00am for placement of asphalt
- Sunday, 20 September, between 7:00pm - 6:00am for placement of asphalt
- Monday, 21 September, 7:00pm - 6:00am – for removal and reinstatement of line marking
- Tuesday, 22 September, between 7:00pm - 6:00am for removal and reinstatement of line marking
- Wednesday, 23 September, between 7:00pm - 6:00am for removal and reinstatement of line marking

[dit.sa.gov.au](http://dit.sa.gov.au)

Follow us on:    



Australian Government

**BUILDING OUR FUTURE**



Government  
of South Australia

Department for Infrastructure  
and Transport

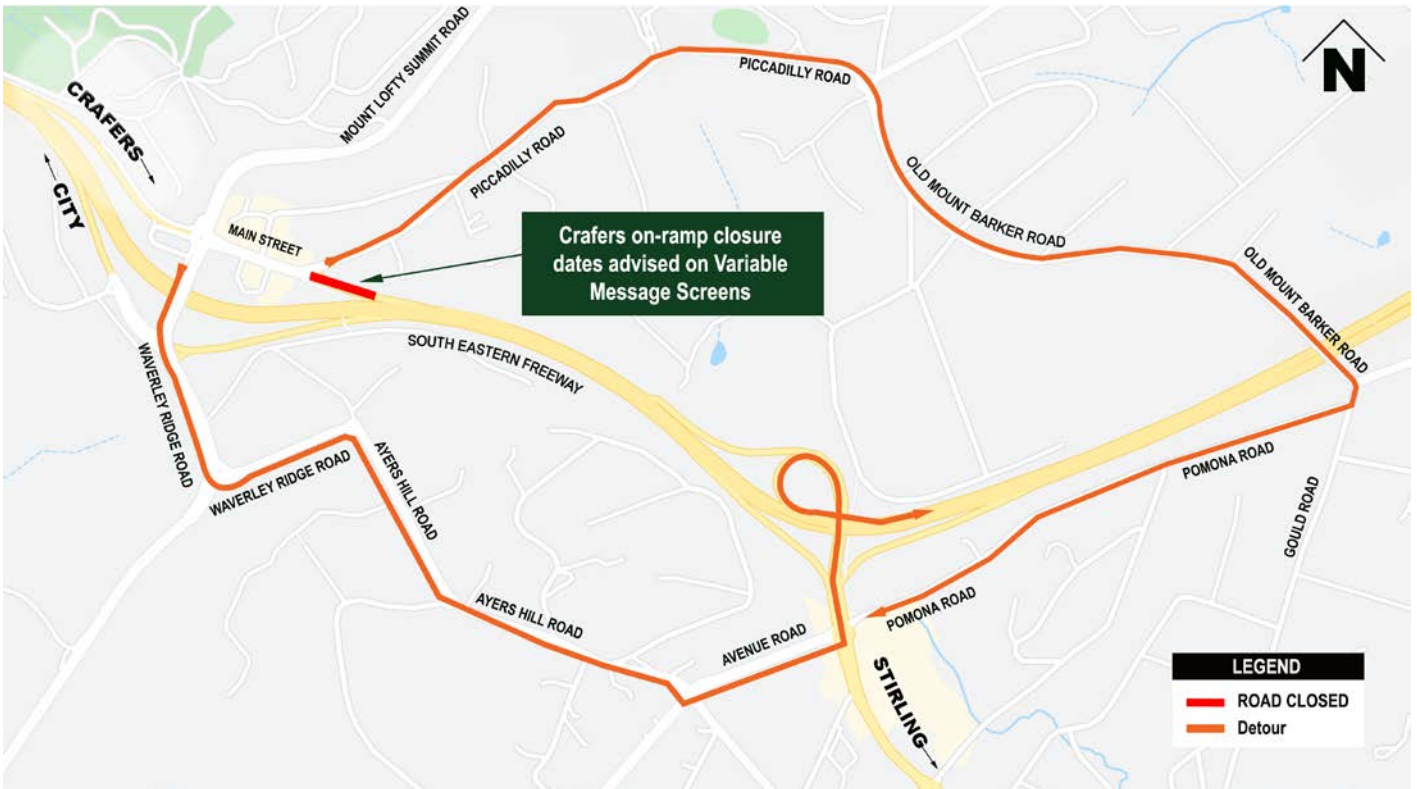

### Stirling Outbound Off-Ramp

- Monday, 21 September, between 7:00pm - 6:00am for removal and reinstatement of line marking
- Tuesday, 22 September, between 7:00pm - 6:00am for removal and reinstatement of line marking
- Wednesday, 23 September, between 7:00pm - 6:00am for removal and reinstatement of line marking

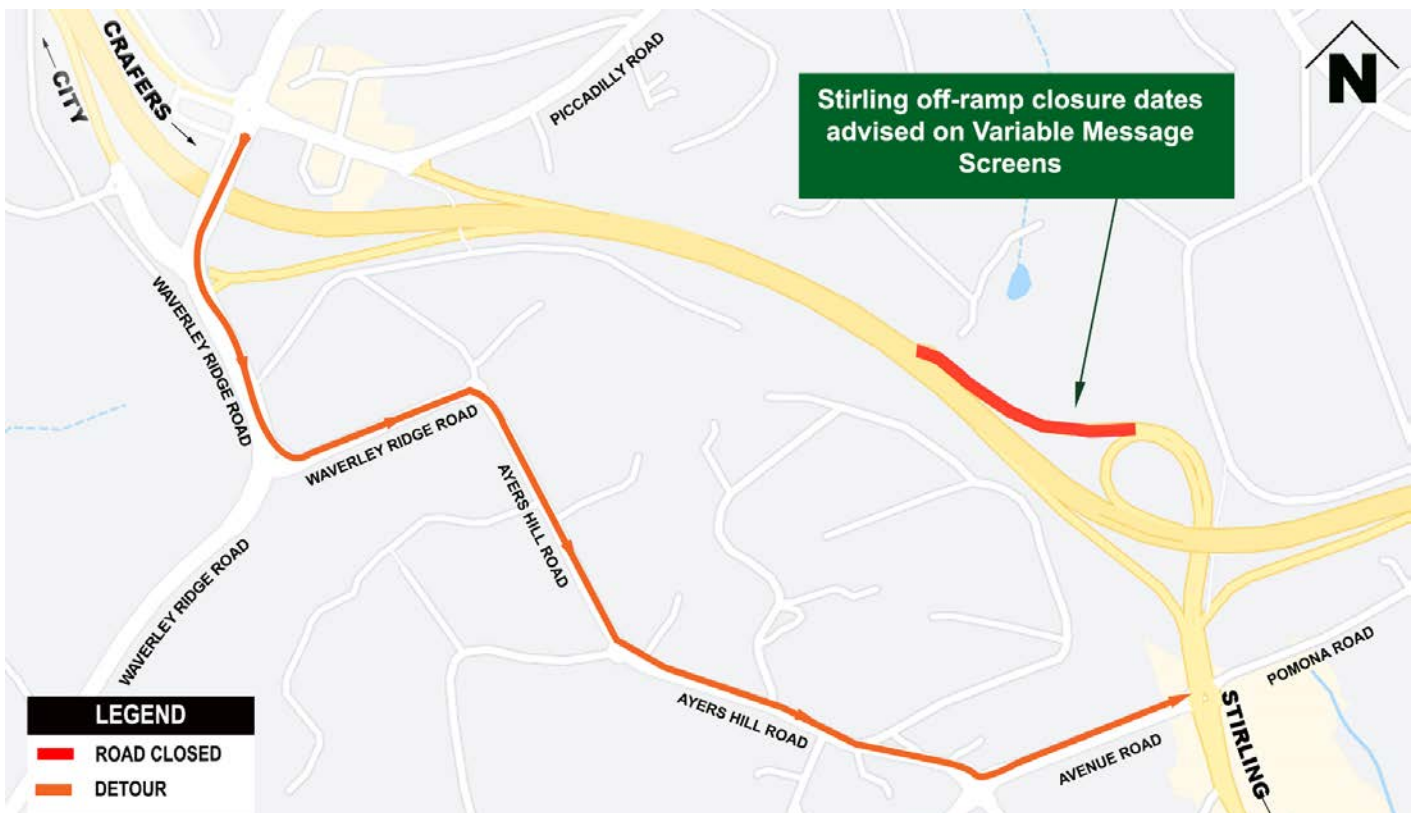

## Stirling Inbound On-Ramp

- Tuesday, 15 September, between 7:00pm - 6:00am for the erection of Lane Use Management mast-arm pole
- Friday, 18 September, between 7:00pm - 6:00am for the erection of camera poles.



These dates may change due to weather or conditions on site. Updates will be advised on Variable Message signs and the Department for Infrastructure and Transport (the Department) will regularly update social media and the project's web page (refer below) with any changes.

Road users are asked to please plan ahead and allow extra travel time, observe speed limits, lane restrictions, traffic controllers and take extra care when travelling through the area.

Some noise disturbance can be expected at times while these works are completed, however the work will be managed to minimise disturbance to local residents and businesses as much as practically possible. Please email the address below to be added to our mailing list for updates if these works are rescheduled due to weather.

If you have any questions or would like to speak to a member of the project team, please call 1300 794 880, email [DIT.communityrelations@sa.gov.au](mailto:DIT.communityrelations@sa.gov.au) or visit [www.dit.sa.gov.au/managedmotorway](http://www.dit.sa.gov.au/managedmotorway)

The Department appreciates your co-operation and patience while these important works are undertaken.

Kind regards,

**Community Engagement and Stakeholder Team**  
**Department for Infrastructure and Transport**