

# North-South Corridor

## Northern Connector Project

### South Road Superway night works – off-ramp closure and detour

As part of the Northern Connector Project, the South Road Superway off-ramp to Salisbury Highway will be closed with detours in place.

**Dates:** From Sunday, 27 October, for three nights, weather permitting.

#### Work hours:

- From 5pm, Sunday, 27 October, until 5am, Monday, 28 October.
- From 7pm Monday, 28 October, until 5am Tuesday, 29 October, and
- From 7pm Tuesday, 29 October until 5am, Wednesday, 30 October.

**Activities:** Relocation and installation of safety barriers, lighting, installation of overhead gantries.

**Traffic management:** Access to the Salisbury Highway will be maintained via a detour to the Hanson Road interchange (refer to map).

Speed and lane restrictions will apply in the vicinity of the works, including the South Road Superway. Signage and traffic management will be in place to advise motorists of changed conditions.

Thank you for your patience while these important works are undertaken.

**More information:** To sign up for traffic updates, please contact the Project Information Line on 1300 916 221 or email your contact details to [northernconnector@lendlease.com](mailto:northernconnector@lendlease.com).

For real time roadwork information visit [www.addinsight.com.au](http://www.addinsight.com.au) and download the app, available for both Apple and Android, or visit the Traffic SA website at [www.traffic.sa.gov.au](http://www.traffic.sa.gov.au).

Follow [www.facebook.com/DPTISA](https://www.facebook.com/DPTISA) for regular project updates.

#14583283

#### For further information:

Call: 1300 916 221

Email: [northernconnector@lendlease.com](mailto:northernconnector@lendlease.com)

Visit: [dpti.sa.gov.au/northernconnector](http://dpti.sa.gov.au/northernconnector)



Government of South Australia

Department of Planning,  
Transport and Infrastructure

# Detour for South Road Superway night works 27-30 October

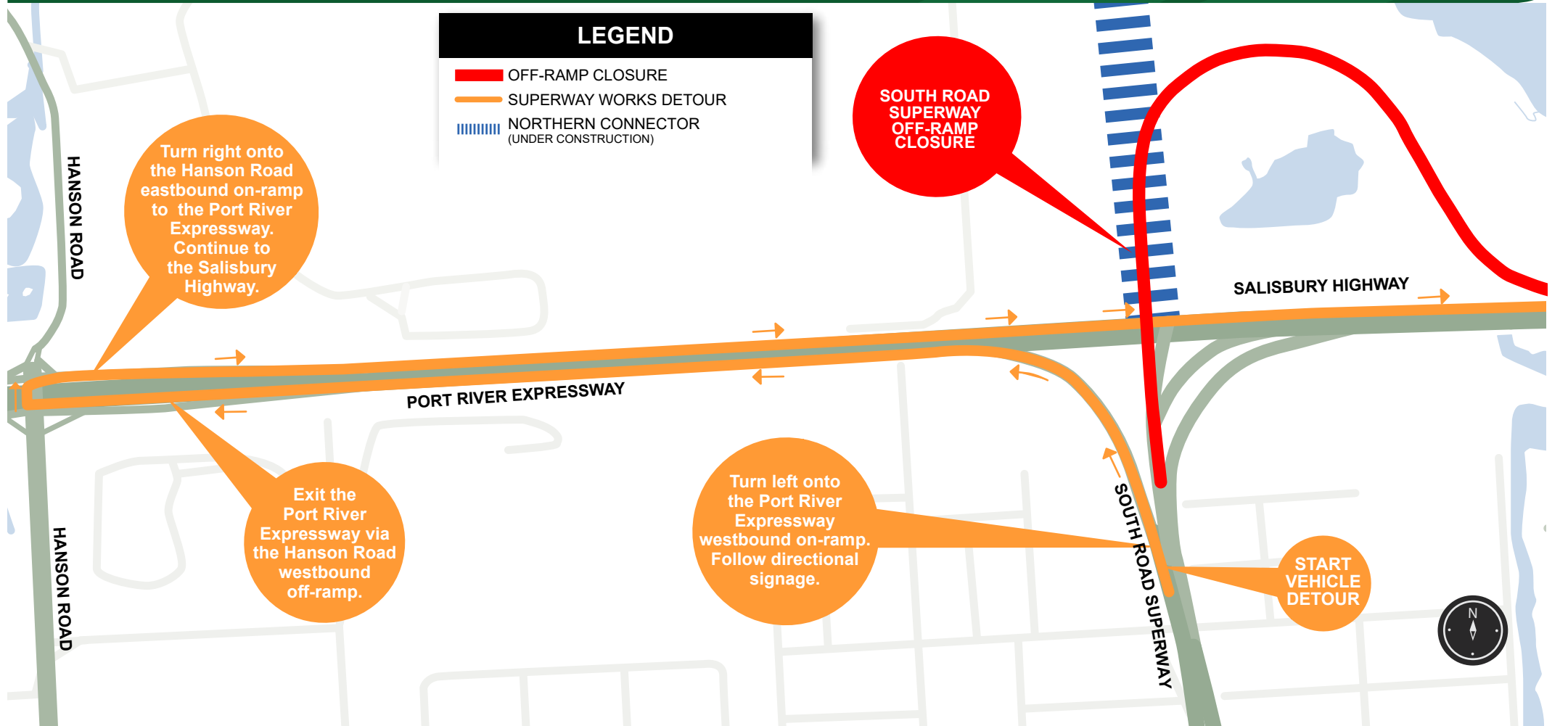

For further information  
Visit: [dpti.sa.gov.au/northernconnector](http://dpti.sa.gov.au/northernconnector)  
Email: [northernconnector@lendlease.com](mailto:northernconnector@lendlease.com)  
Call: 1300 916 221